

**Mandatory Prebid Meeting Agenda  
Western Wake Wastewater Management Facilities**

**Contract 7  
West Cary Force Main, West Reedy Branch Gravity Sewer, and  
Beaver Creek Gravity Sewer  
Town of Cary Project Nos. SW1144, SW1145, SW1178 & 1179  
Single-Prime Contract  
January 19, 2012 at 10 a.m.**

NOTE: Only questions answered by formal written Addenda will be binding.

1. Sign-in: This is a mandatory pre-bid meeting. Today's sign-in sheet will be used to verify attendance prior to bid opening on Feb 7, 2012.
2. Introductions, Project Overview and Schedule
  - Western Wake Partners – Cary, Apex, Morrisville. [westernwakepartners.com](http://westernwakepartners.com)
  - Town of Cary – Project lead
  - Hazen and Sawyer – CA for Contracts 1 – 8, and Design Engr for Contracts 4 – 8
  - Contract 7 documents available for view for convenience on Town of Cary website.
  - See attached for overview on all eight WWRWMF Contracts.
3. Contract 7 Description (3 in 1)

Note: Virtually the entire project entire runs through or is surrounded by privately owned property, and the successful bidder will be required to work with the engineer to coordinate closely with the public and private property owners to provide access and minimize impacts of construction during the entire construction process.

Also, the requirements of all applicable NCDOT encroachment agreements (EA) and 401/404 permits are incorporated into this Contract by reference and the cost of these requirements must be included in the Bidder's proposal. The most recent version of EA and 401/401 permits will be posted on Partner's website or issued via addendum prior to bid.

**Lump Sum = Bid Items A, B C and D**

- A. SW1145 - West Reedy Branch Gravity Sewer (GS):
  - Cast in place concrete junction box approx 14' x 16' x 15'D
  - 1 mile of 48" GS and 1 mile of 54" GS
  - Ends at Beaver Creek Pump Station (Contract No. 6 by PC Construction)
  - No access to WRBGS from Olive Chapel Road
  - All manholes with rim below 100-yr flood EL require water tight covers
  - 280-LF 72" jack and bore under Hwy 64
  - 90-LF of 72" jack and bore under Jenks Road
  - 200-LF aerial crossing
  - Various stream crossings and wetland crossing
  - DIP, Steel or CCFRMP allowed for non-restrained buried pipe (operated by Cary)
  - All piping for aerials and bores shall be restrained

- B. SW1179 - Beaver Creek Gravity Sewer (GS) Sta 10+00 to 29+12:
- Starts at Beaver Creek Pump Station (Contract No. 6 by PC Construction)
  - 0.4 miles of 42" GS
  - 90-LF 60" jack and bore under Olive Chapel Road
  - 1,300-LF 84" tunnel through 34 to 70-ft of cover – no access above tunnel
  - DIP pipe only (operated by Apex)
  - All piping for tunnels and bores shall be restrained
- C. SW1178 - Beaver Creek Gravity Sewer (GS) Sta 29+12 to 49+45:
- 0.3 miles of 42" GS and 360-LF of 36" GS
  - 140-LF 60" jack and bore under Richardson Road
  - DIP pipe only (operated by Apex)
  - All piping for tunnels and bores shall be restrained
  - Ends at Sta 49+45. Continuation of 36" GS by others.
- D. SW1144 - West Cary Force Main:
- Starts at West Cary Pump Station (Contract No. 6 by PC Construction)
  - Two new parallel 30" FM's over approximately 2.2 miles from existing West Cary Pump Station to transition junction box on Cary-Apex WTP property.
  - DIP or Steel allowed for pipe (operated by Cary)
  - Special lining at air release valves and junction box
  - Various wetland crossing
  - 80-LF of 42" jack and bore under White Oak Creek – crossing prohibited
  - 140-LF of 42" jack and bore under Gas Easement – cross only via existing roads
  - Open cut of Wimberly Road requiring Detour
  - Payment Item 20: portion of Cathodic Protection System

**Additive Alternate Bid Items E, F, G, and H (Payment Item 21)**

- E. SW1145 – West Reedy Branch Gravity Sewer Cathodic Protection
- F. SW1179 – Beaver Creek Gravity Sewer STA 10+00 to STA 29+12 Cathodic Protection
- G. SW1178 – Beaver Creek Gravity Sewer STA 29+12 to 49+45 Cathodic Protection
- H. SW1144 – West Cary Force Mains Cathodic Protection not included in Payment Item 20

Note: Owner may elect to award any combination of Alternate Bid Items (none, 1 or more)

4. Coordination with Other Contracts

- Section 01300 Document Management System
- Section 01310 CPM Construction Schedule
- Section 00500, Time is of the Essence, Owner cannot make beneficial use of Contract 7 until other Contracts complete
- Anticipated NTP May 1, 2012

5. Bidding

- **Bid Opening: Tues, Feb 7, 2012.**
- Section 00300 – Proposal Section
  - Lump sum for Bid Items A, B, C and D
  - Additive Alternate Bid Items E, F, G and H
  - MBE documentation – Identification, Total Value, Affidavit A or B
- Section 00250 – Instructions to Bidders
- Attend January 19, 2012 mandatory prebid
- Must be “Bidding Documents Holder”; purchased from Hazen and Sawyer (current list attached)
- Town of Cary Privilege License required for award
- Bids may be held open for 90 days, May 7, 2012
- Bid package to be bound (no loose pages) and to include:
  1. Bid Bond (using forms provided herein), or other allowable bid security;
  2. Power of Attorney
  3. Bidder’s Certificates, Affidavit of Organization and Authority Sworn Statement;
  4. Equal Employment Opportunity Addendum;
  5. Qualifications of Bidders;
  6. Non-Collusive Affidavit;
  7. Non-discrimination Clause;
  8. Minority Participation Documents.
  9. Photocopy of Bidder’s North Carolina Contractors License;
  10. Statement of Compliance with requirement that the Bidder will ensure at least half of the work is performed with the Bidder’s employees (provide statement on Bidder’s letterhead)

6. Addendum

- Per Section 00250, Bidder has the responsibility to make inquiry as to addenda issued. All addenda will be on file with Engineer and Owner 24 hours before bids are opened
- Currently last business day for bidder questions Feb 3, 2012.
- We welcome questions but will not answer them directly.
- Send questions to [ww7@hazenandsawyer.com](mailto:ww7@hazenandsawyer.com)
- Only questions answered by formal written Addenda will be binding.

7. Site Visits: By appointment only. Contact Francis Buser, Hazen and Sawyer, at 919-833-7152, or [ww7@hazenandsawyer.com](mailto:ww7@hazenandsawyer.com)

8. Questions

# Overview of Western Wake Wastewater Management Facilities

## WWWMF Contracts

1. **Liquid Facilities** – \$77M, awarded to Crowder, NTP Sept 2011, SC May 2014
2. **Solids Facilities** – current bid date Dec 6, 2011
3. **Admin, Ops & Maint Facilities** – projected bid 1<sup>st</sup> quarter 2012
4. **Effluent Pump Station** - projected bid 2<sup>nd</sup> quarter 2012
5. **Effluent Force Main** – project bid 2<sup>nd</sup> quarter 2012
6. **Influent Pumping** – \$21M, awarded to PC Construction, NTP March 2012
7. **Conveyance into BCPS** – current bid date Tues, Feb 7, 2012 at 1:30 p.m., NTP May 2012
8. **BCPS Force Main** - projected bid 1<sup>st</sup> quarter 2012

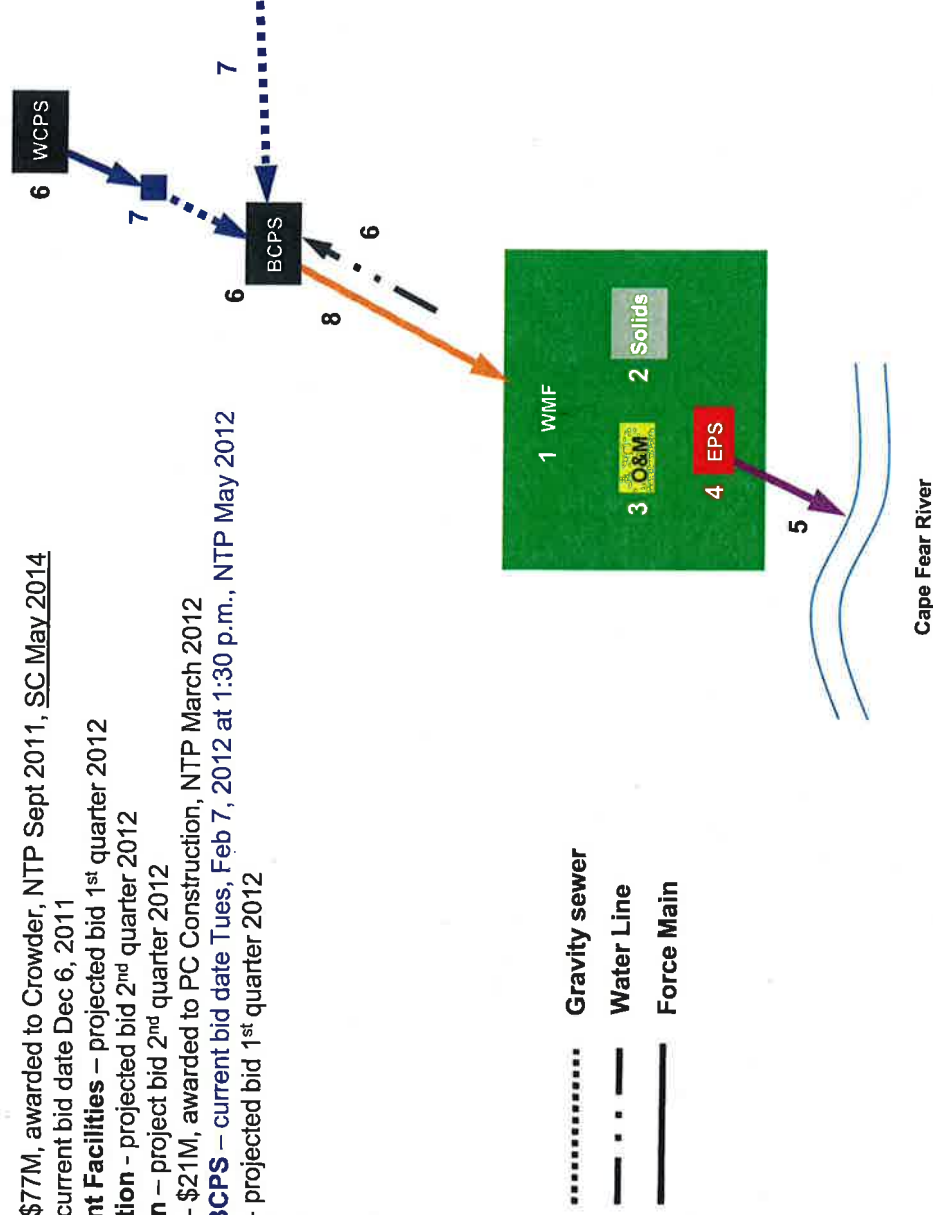

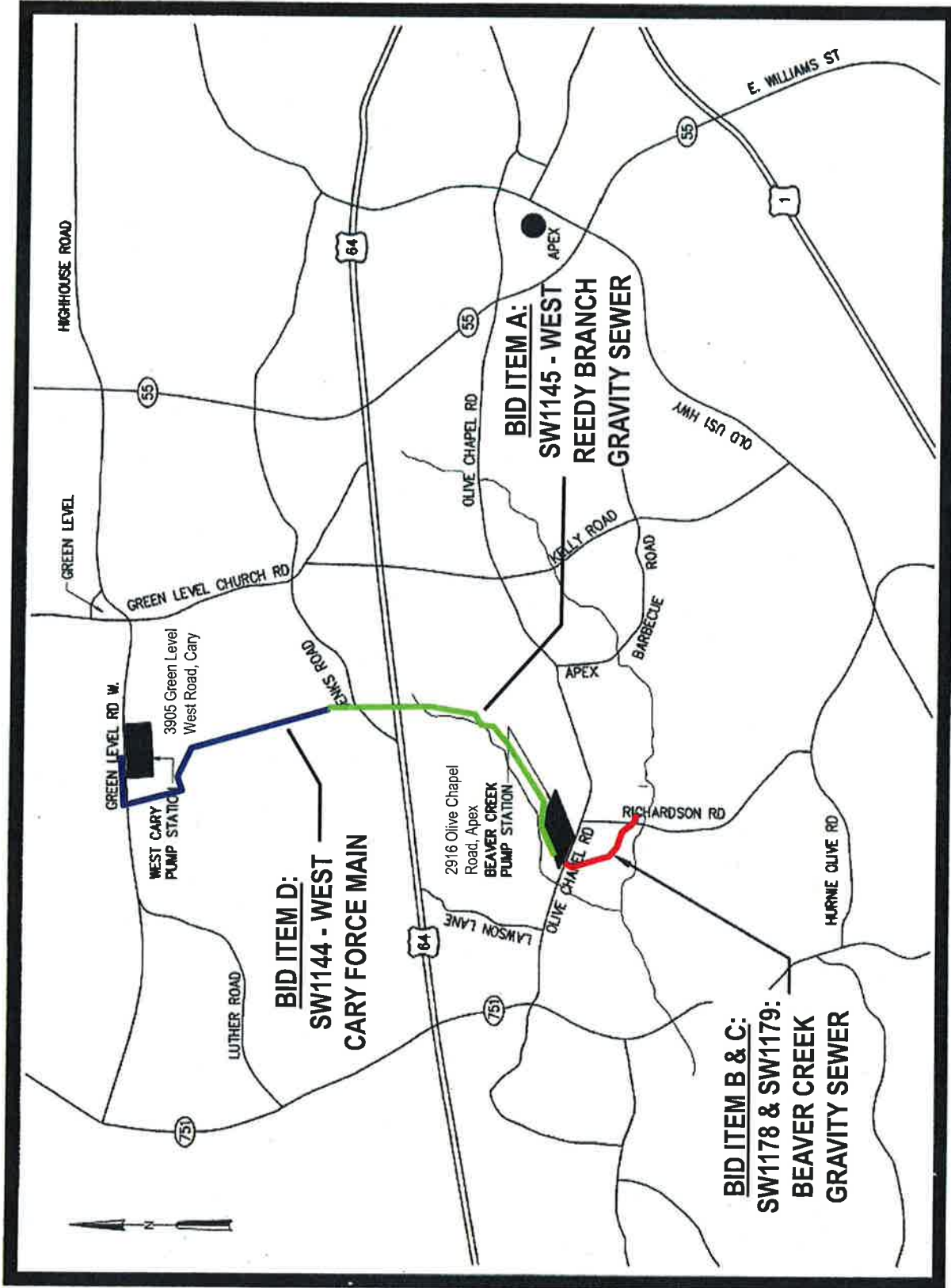

**LOCATION MAP**

## **BID ITEM D**

### SW1144 - West Cary Force Main:

- Starts at West Cary Pump Station (Contract 6)
- Two new parallel 30" FM's over approximately 2.2 miles from existing West Cary Pump Station to transition junction box on Cary-Apex WTP property.
- DIP or Steel allowed for pipe (operated by Cary)
- Special lining at air release valves and junction box
- Various wetland crossing
- 80-LF of 42" jack and bore under White Oak Creek – crossing prohibited
- 140-LF of 42" jack and bore under Gas Easement – cross only via existing roads
- Open cut of Wimberly Road requiring Detour
- Payment Item 20: portion of Cathodic Protection System

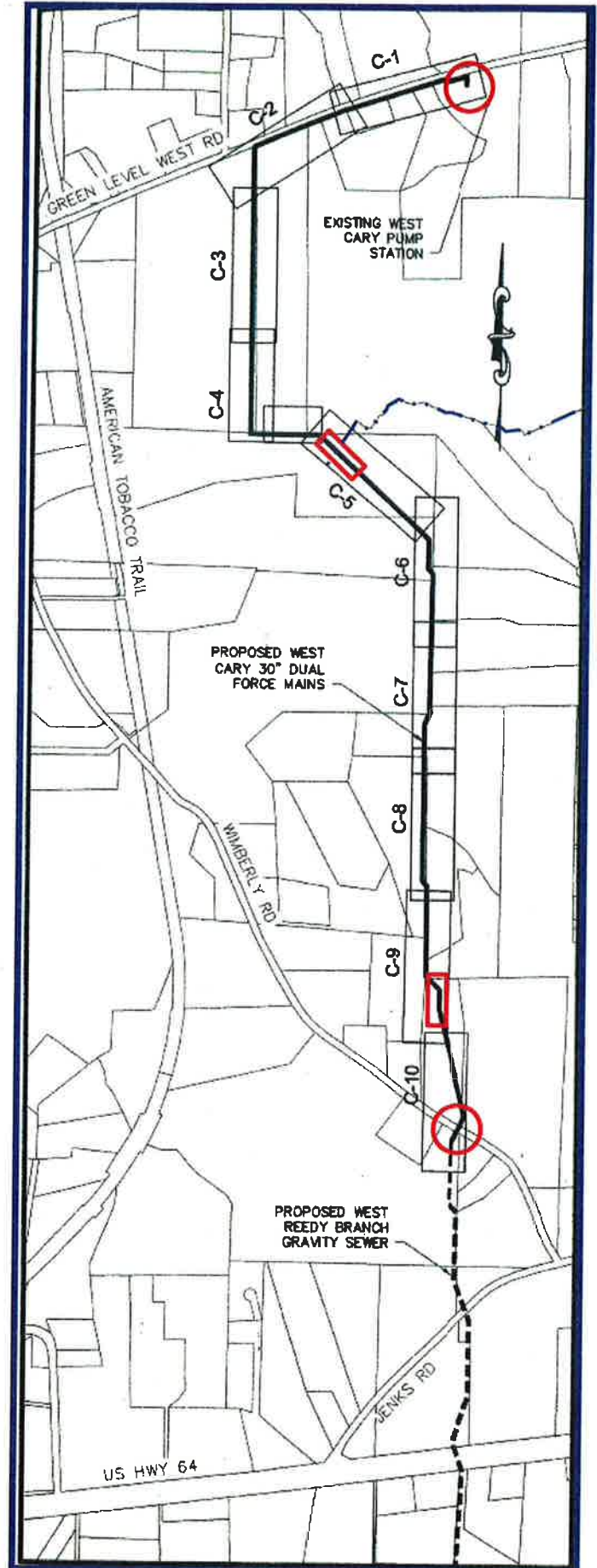

## BID ITEM A

### SW1145 - West Reedy Branch Gravity Sewer (GS):

- Cast in place concrete junction box
- 1 mile of 48" GS and 1 mile of 54" GS
- Ends at Beaver Creek Pump Station (Contract 6)
- No access to WRBGS from Olive Chapel Road
- All MH below 100-yr flood EL require water tight covers
- 280-LF 72" jack and bore under Hwy 64
- 90-LF of 72" jack and bore under Jenks Road
- 200-LF aerial crossing
- Various stream crossings and wetland crossing
- DIP, Steel or CCFRMP allowed for non-restrained buried pipe
- All piping for aerials and bores shall be RJ

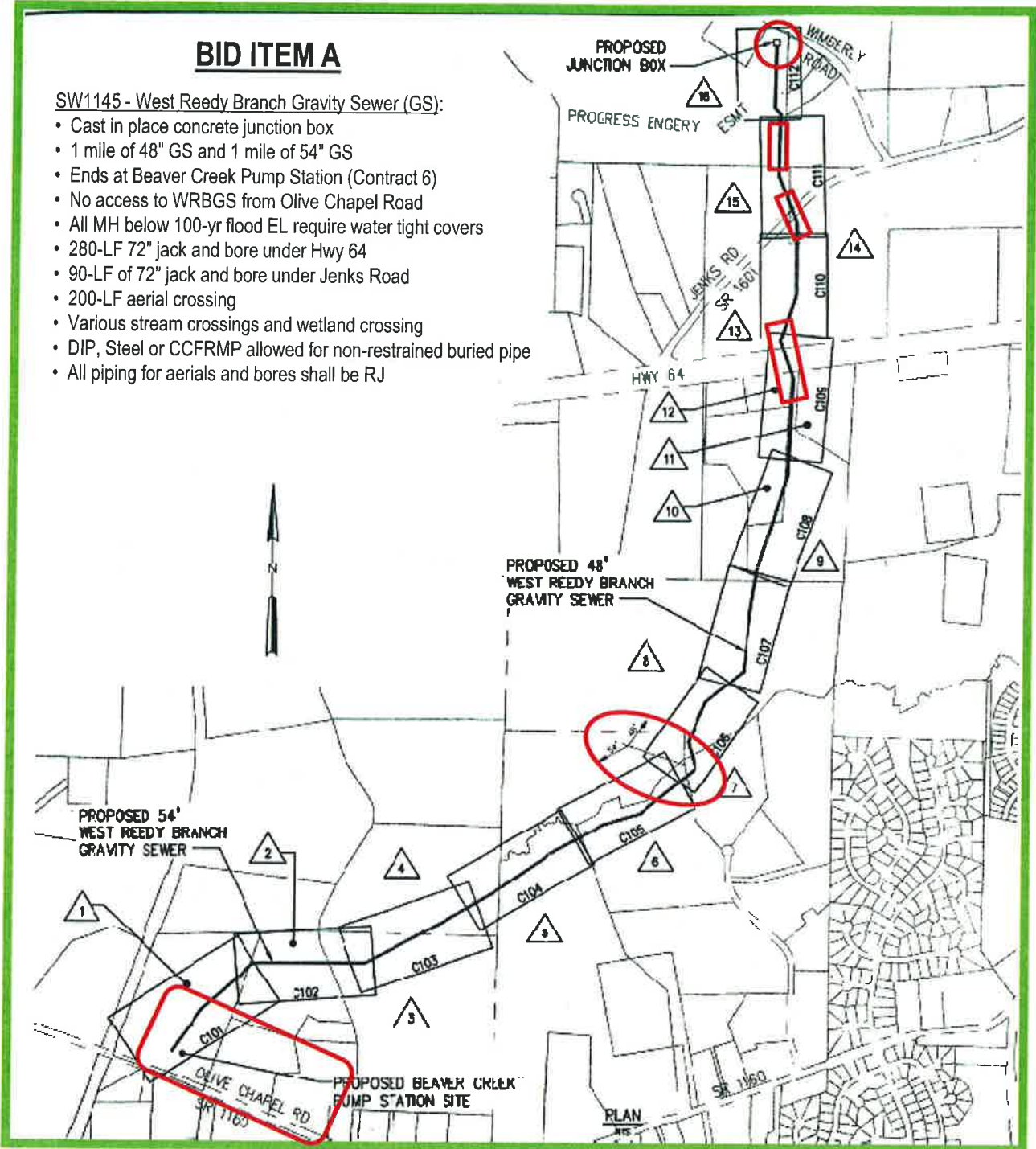

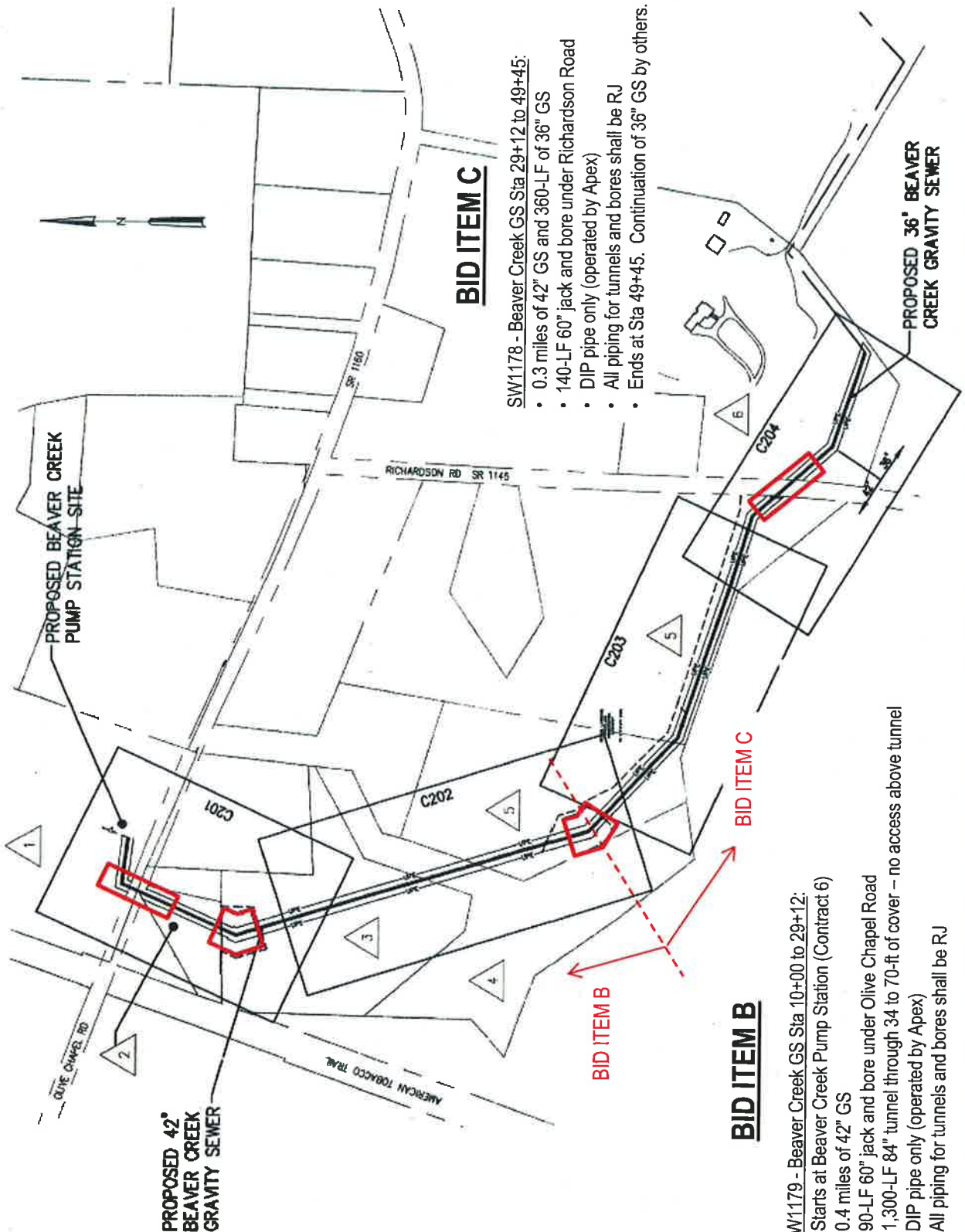

**PROPOSED 42" BEAVER CREEK GRAVITY SEWER**

**PROPOSED BEAVER CREEK PUMP STATION-SITE**

**BID ITEM C**

- SW1178 - Beaver Creek GS Sta 29+12 to 49+45:**
- 0.3 miles of 42" GS and 360-LF of 36" GS
  - 140-LF 60" jack and bore under Richardson Road
  - DIP pipe only (operated by Apex)
  - All piping for tunnels and bores shall be RJ
  - Ends at Sta 49+45. Continuation of 36" GS by others.

**PROPOSED 36" BEAVER CREEK GRAVITY SEWER**

**BID ITEM B**

**BID ITEM B**

- SW1179 - Beaver Creek GS Sta 10+00 to 29+12:**
- Starts at Beaver Creek Pump Station (Contract 6)
  - 0.4 miles of 42" GS
  - 90-LF 60" jack and bore under Olive Chapel Road
  - 1,300-LF 84" tunnel through 34 to 70-ft of cover – no access above tunnel
  - DIP pipe only (operated by Apex)
  - All piping for tunnels and bores shall be RJ

**Plan Holders List**

**Full Size \$400.00/ Half Size \$200.00 S/H \$25.00**

**1/19/12**

**H&S Project No. 30558--003**

**Town of Cary Contract 7 West Reedy Branch and Beaver Gravity Sewers & West Cary  
Force Main**

**1/2**

**Pre Bid Date January 19, 2012 10:00 AM (Mandatory)**

**Bid Date February 7, 2012 1:30 PM**

---

1.	Carolina's AGC	Raleigh, NC	919-781-3270
2.	Carolina's AGC	Charlotte, NC	704-372-1450
3.	McGraw- Hill Dodge	Arlington, TX	704-599-9460
4.	Hispanic Contractors	Raleigh, NC	919-426-3029
5.	Raleigh Business & Technology	Raleigh, NC	919-836-8618
6.	CDC News	Cary, NC	919-854-9540
7.	Park Construction	Morrisville, NC	919-319-8801
8.	Sullivan Eastern Inc.	Durham, NC	919-484-8993
9.	Ruby- Collins Inc.	Smyrna, GA	770-432-2900
10.	Reynolds Inc.	Fairburn, GA	770-969-4040
11.	Sanford Contractors	Sanford, NC	919-775-7882
12.	Hall Contracting Corp.	Charlotte, NC	704-598-0818
13.	Capitol Tunneling	Columbus, GA	614-444-0255
14.	Thalle Construction	Hillsborough, NC	919-241-1620
15.	Triangle Grading & Paving	Burlington, NC	336-584-1745
16.	Hobas Pipe USA	Fuquay- Varina, NC	832-622-8883
17.	Hobas Pipe USA	Houston, TX	281-821-2200

**Plan Holders List**

**Full Size \$400.00/ Half Size \$200.00 S/H \$25.00**

**1/19/12**

**H&S Project No. 30558--003**

**Town of Cary Contract 7 West Reedy Branch and Beaver Gravity Sewers & West Cary  
Force Main**

**2/2**

**Pre Bid Date January 19, 2012 10:00 AM (Mandatory)**

**Bid Date February 7, 2012 1:30 PM**

---

<b>18.</b>	<b>State Utility Contractors</b>	<b>Monroe, NC</b>	<b>704-289-6400</b>
<b>19.</b>	<b>T.A. Loving Co.</b>	<b>Goldsboro, NC</b>	<b>919-734-8400</b>
<b>20.</b>	<b>Moorhead Construction</b>	<b>Belton, SC</b>	<b>864-338-5388</b>
<b>21.</b>	<b>D.H. Griffin</b>	<b>Greensboro, NC</b>	<b>336-389-5388</b>
<b>22.</b>	<b>Gary's Grading &amp; Pipeline</b>	<b>Monroe, NC</b>	<b>770-267-0825</b>
<b>23.</b>	<b>Garney Construction</b>	<b>Alpharetta, GA</b>	<b>770-754-4141</b>
<b>24.</b>	<b>Strack Inc</b>	<b>Fairburn, GA</b>	<b>770-969-1591</b>
<b>25.</b>	<b>Devere Construction</b>	<b>Alpena, MI</b>	<b>877-338-3731</b>
<b>26.</b>	<b>Morgan Contracting</b>	<b>Baker, FL</b>	<b>850-537-5000</b>
<b>27.</b>	<b>B.R.S. Inc.</b>	<b>Richfield, NC</b>	<b>704-463-1355</b>